

Hotel Accommodations

You can make your hotel reservation at the Holiday Inn City Centre or the University Plaza. The rate for each hotel is \$93.00 for a single or double. Contact information is listed below. **Deadline** for the block rooms is August 2, 2010. The Days Inn rate is \$49.99. **Deadline** for the Day Inn block is August 10, 2010.

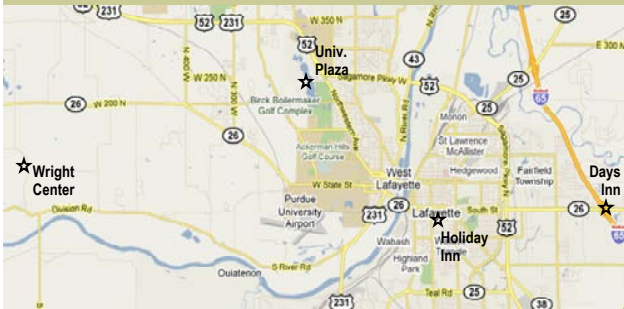

Days Inn, 151 Frontage Road, Lafayette, IN

Reserve a room by telephone at 765-446-8558 or online at www.lafayettedaysinn.com.

(Code is Society of American Foresters.)

Holiday Inn City Centre, 515 South Street, Lafayette, IN

Reserve a room by telephone at 800-423-1137 or online at www.hiscc.com.

(Code is SAF.)

University Plaza, 3001 Northwestern Avenue, West Lafayette, IN

Reserve a room by telephone at 800-777-9808 or online at www.universityplazahotelwestlafayette.com.

(Code is INFORESTERS.)

Directions from Wright Center to Hotels.

Days Inn—Start out going South on N. CR 725 W toward Robert Ross Lane. Turn Left onto Division Road. Stay Straight to go onto S. River Road. Turn Left onto S. River Rd/US-231. Turn Right onto Tapawingo Drive. Turn Right onto IN-26 E. Turn Left onto Frontage Road. Hotel is on the Right.

Holiday Inn City Centre— Start out going South on N CR 725 W toward Robert Ross Lane. Turn Left onto Division Road, Turn left onto S. River Rd/US-231, Turn Right onto Tapawingo Drive, Turn Right onto IN-26 E, Hotel is on the Right.

University Plaza— Start out going Northwest on N CR 725 W toward W CR 125 N. Turn Right onto N CR 750 W. Turn Right onto IN-26. Stay Straight to go onto W CR 200 N/Lindberg Road. Turn Left onto N. CR 400 W. Turn Right onto US-52 E/US-231 S. Turn Right onto Cumberland Ave. Hotel is on the Right.

Directions to the John S. Wright Forestry Center 1011 North 725 West West Lafayette, IN 47906

The center is reached by driving seven miles west on SR 26 from the Purdue University campus to County Road 750 W, turning left (south) on 750 W to stop sign, then left (east) onto County Road 125 N, which turns into County Road 725 W. Entrance is on the left at the bottom of the hill and marked Martell Forest. This is where the Wright Center is located. Turn into the entrance. Follow the gravel road. The Wright Center is on the left.

Note: Cell phone reception is not reliable at the Center. (765-583-3505 or 765-583-3501 may be left for contact numbers.)

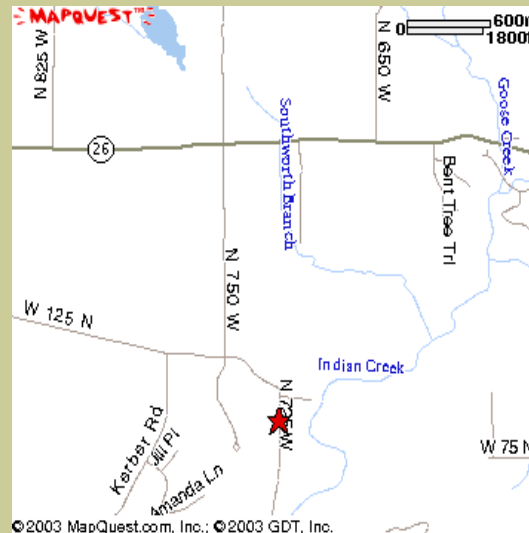

For more information contact—

Mike Saunders
Purdue University
715 W. State Street
West Lafayette, IN 47907-2061
Phone: 765-494-2155
Fax: 765-494-9461
E-mail: msaunders@purdue.edu

2010 Summer Meeting Indiana Chapter of the Society of American Foresters



Hardwood Tree Improvement Research in the Central States



September 1 & 2, 2010
Wright Center (Martell Forest)
West Lafayette, IN

Society of American Foresters

This meeting will highlight activities of the Hardwood Tree Improvement and Regeneration Center over its first decade of existence at Purdue University. Presentations will focus on past and future tree improvement research activities, including discussions on invasive species, tissue culture systems, fertigation systems, and breeding trials.

Meeting location is the Wright Center located at the Martell Forest near West Lafayette, Indiana. Registration cost is \$75.00 for members and \$100.00 for non-members. Blocks of hotel rooms have been reserved in West Lafayette and Lafayette.

This program has been reviewed and is approved for professional CFE credits by the Society of American Foresters.

Category 1 -
CF: 7.5 hours



Time:	Wednesday, September 1, 2010 Auditorium
10:00 AM	INSAF Executive Committee Meeting
12:00 PM	Registration
12:45 PM	Greeting
1:00 PM	Where has the first decade of HTIRC research brought us and where are we headed? — <i>Charles Michler, Director, USDA Forest Service, HTIRC</i>
1:45 PM	Tissue culture systems research — <i>Paula Pijut, Research Plant Physiologist, USDA Forest Service, HTIRC</i>
2:30 PM	Break
2:45 PM	Chestnut breeding research — <i>Jim McKenna, Operational Tree Breeder, USDA Forest Service, HTIRC</i>
3:10 PM	Indiana's Statewide Forest Assessment & Strategy — <i>Chris Gonso, Division of Forestry, IN DNR</i>
3:35 PM	Thousand canker update — <i>Phil Marshall, Director, Division of Entomology and Plant Pathology, IN DNR</i>
4:00 PM	Break
4:15 PM	ISAF Business Meeting
5:30 PM	BBQ
6:30 PM	Mini-Conclave, Corn-Hole & Euchre Tournament <i>Hosted by the Purdue Student Chapter of SAF</i>
8:30 PM	Adjourn
	Thursday, September 2, 2010 Field Trip
8:30 AM	Load bus and depart the Wright Center
8:45 AM	State-of-the-art walnut fertigation and breeding systems — <i>Guillermo Pardillo, Deputy CEO, ArborAmerica, Inc.</i>
10:15 AM	Characterization of walnut crown ideotypes — <i>Keija Pang, PhD Student, Forestry & Natural Resources, Purdue</i>
10:30 AM	Break
10:45 AM	Walnut pruning study — <i>Mike Saunders, Forestry & Natural Resources, Purdue</i>
11:05 AM	TBA
11:30 AM	Load bus
11:45 AM	Lunch at Wright Center

Time:	Thursday, September 2, 2010 Field Trip (continued)
1:00 PM	Current status of butternut canker resistance breeding and research — <i>Keith Woeste, Molecular Geneticist, USDA Forest Service, HTIRC</i>
1:45 PM	Load bus
2:00 PM	Chestnut afforestation work: Mixed species competition study — <i>Kate Zellers, PhD Student, Forestry & Natural Resources, Purdue</i>
2:45 PM	Load bus
3:00 PM	Chestnut reforestation work: Cox-Haggarty underplanting study — <i>Brian Bailey, MS Student, Forestry & Natural Resources, Purdue</i>
3:45 PM	Load bus
4:00 PM	Arrive at Wright Center and adjourn

**2010 Indiana Society of American Foresters
September 1 & 2, 2010
Wright Center, West Lafayette, Indiana**

Deadline is August 23, 2010

Name: _____
Please include first and last names of all that will be attending for nametags.

Address: _____

City: _____

State and Zip: _____

Phone: _____

Email: _____

Member Registration: _____ @ \$75 each \$ _____

Nonmember Registration: _____ @ \$100 each \$ _____

Executive Committee Lunch: _____ @ \$10 each \$ _____

Please make check payable to Purdue University.

Send this registration form and check to:

**Purdue University
Janis Gosewehr
715 W. State Street
West Lafayette, IN 47907-2061**